

Installation Instructions Northwoods™ Shakes and Shingles

These instructions describe and illustrate the steps involved in installing CertainTeed siding and trim. Their purpose is to provide detailed information and how-to tips that will simplify the installation process. CertainTeed shall not accept any liability or responsibility under its written warranty for failure caused by application that does not meet our minimum requirements for proper installation. These requirements are outlined throughout the *CertainTeed Installation Guide (CTS205)*. Any deviations from these requirements should be approved in writing by CertainTeed Corporation.

NOTE: *Vinyl siding must be applied over a rigid sheathing that provides a smooth, flat surface or an underlayment (such as wood, wood composition, rigid foam or fiber sheathing) that is no more than 1" thick. Vinyl siding cannot be applied directly to studs.*

The installation of a Northwoods Shakes or Shingles panel is unique in that the lap joint is hidden in the ribs between the shake or shingle patterns. Positioning the laps in the rib area requires that special installation procedures be followed to maintain product performance and aesthetics.

Factory Laps: All lap joints are cut at a predetermined point on the panel during the manufacturing process. All male laps must be factory cut. Female laps may be cut using the gap. However, do not cut along the edge of the gap; leave 3/16" of the gap for the overlap.

Panels must be installed from right to left. The left panel will overlap the right panel.

Center Pinning

Vinyl siding expands and contracts as the temperature of the panel changes. To maintain the proper rib width at the lap joint, you will have to limit the movement of the panels. To do this, you must center pin each panel. Center pinning prevents the rib width at the lap joint from becoming too wide or too narrow. Each panel contains a short vertical slot, which is perpendicular to the nail slots. This slot marks the center of the panel. **Center pin each panel regardless of its length.**

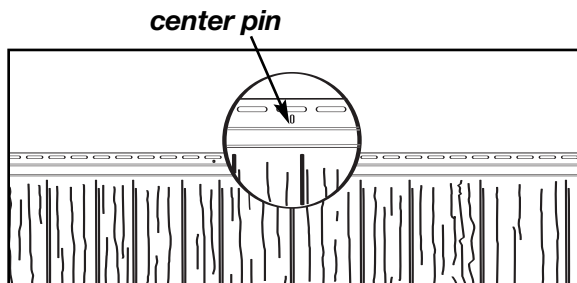

Installation procedure for fully nailable substrate

Lock the right side panel into place on the starter strip. Allow room for expansion and contraction in all accessory pockets:

- 1/4" if the ambient temperature is above 40° F.
- 3/8" if the ambient temperature is below 40° F.

Locate the short, vertical slot on the nail hem and center pin the panel in this location using one of the following options:

- a. Install a nail on both ends of the same nail slot.
- b. Pin the panel by fastening directly through the nail hem.
- c. Drill a 3/16" diameter hole through the nail hem and substrate, and place a single fastener through this newly drilled hole.

Install nails in the center of the remaining slots, 16" apart. Leave adequate room between the fastener head and the nail flange for expansion and contraction (approximately 1/16" to 1/8"). Do not hard nail these fasteners.

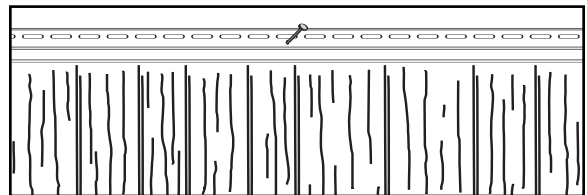

Install the next panel to the left of the installed panel. Lap this panel over the installed panel, positioning the right edge of the panel to the appropriate temperature mark, which is located in the factory notch area.

If the ambient temperature is less than 45°F, lap the panel to the first (30°) mark.

If the ambient temperature is between 45°F - 80°F, lap the panel to the second (65°) mark.

If the ambient temperature is greater than 80°F, lap the panel to the third (100°) mark.

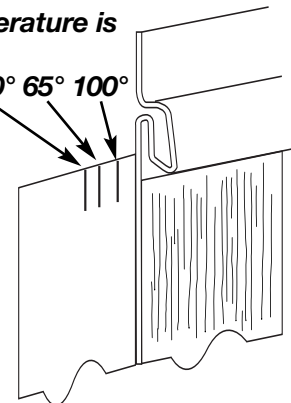

Fasten the panel according to the procedure described earlier.

Continue the first course of siding, remembering to center pin **ALL** panels.

Start the next course of siding from the right side, repeating the earlier steps. Offset the laps from course to course a minimum of 2 feet.

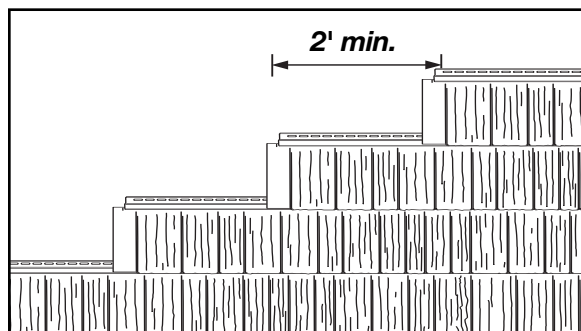

Installation procedure for a NON-fully nailable substrate

Lock the right side panel into place on the starter strip. Allow room for expansion and contraction in all accessory pockets:

- 1/4" if the ambient temperature is above 40° F.
- 3/8" if the ambient temperature is below 40° F.

Locate the short, vertical slot on the nail hem (which indicates the center of the panel). Locate the framing member (wall stud) nearest the center of the panel and **center pin** the panel into the framing member using one of the following options:

- a. If a nail slot is located over the framing member, install a nail on both ends of the same nail slot.
- b. Pin the panel by fastening directly through the nail hem.
- c. Drill a 3/16" diameter hole through the nail hem and framing member, and place a single fastener through this newly drilled hole.

Install nails in the center of the remaining slots, 16" apart, secured into a framing member. Leave enough room between the fastener head and the nail flange for expansion and contraction (approximately 1/16" to 1/8").

Do not hard nail these fasteners.

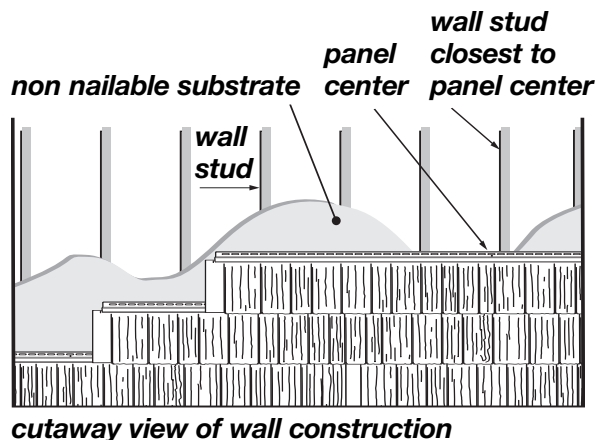

cutaway view of wall construction

Install the next panel to the left of the installed panel. Lap this panel over the installed panel, positioning the right edge of the panel to the appropriate temperature mark.

Fasten the panel according to the procedure described earlier and continue the course of siding.

Start the next course of siding from the right side, repeating the steps described earlier. Offset the laps from course to course a minimum of 2 feet.

If you have any questions about installing this product, please call us at 800-233-8990.